

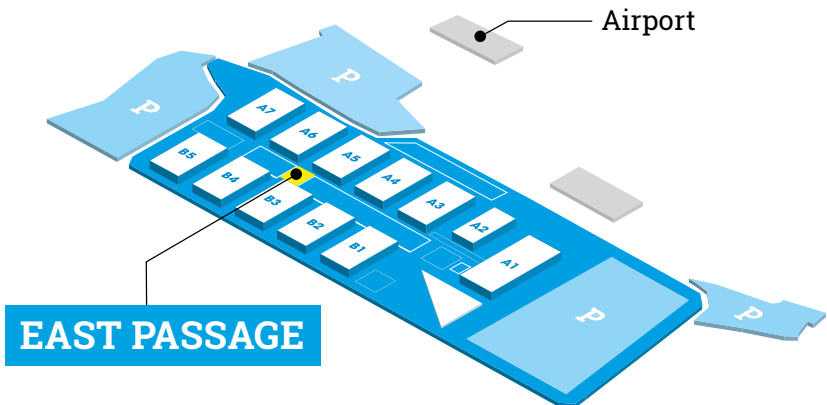

**EAST  
PASSAGE**

# EAST PASSAGE

The East Passage is perfect for staging shows at the show. Be it a gallery, special themes or individual experience spaces – this compact room model opens up a number of interesting options.



Covered interconnection  
A-axis / B-axis for more  
flexible hall use

Full of light thanks to  
room-height glazing

Total Area:

**1,150 m<sup>2</sup>**

Floor load  
in transit area

**5 t/m<sup>2</sup>**

Floor load  
in exhibition area

**500 kg/m<sup>2</sup>**

# EAST PASSAGE

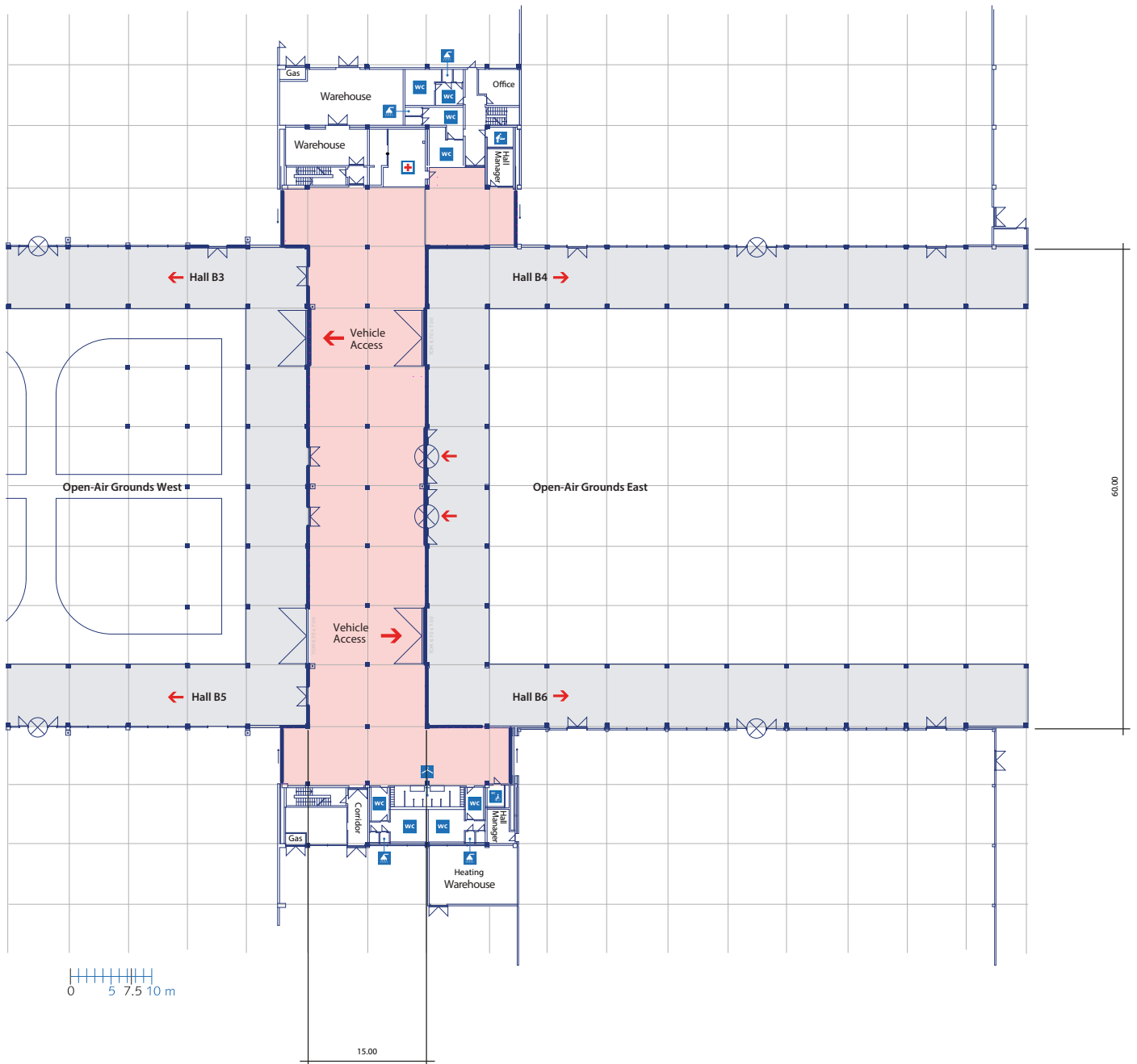

All dimensions in m